

# House & Land Package



\$658,072



## Elara Coastal

Lot 207, The Rochedale Estates

**The Rochedale Estates** - Located just 12kms south of Brisbane's CBD, it is perfectly positioned close to schools, shopping and restaurants.

- Open plan living
- Under roof alfresco
- Large master suite



Price correct 27/05/2011



2009 HIA Australian & 2010 Queensland Professional Major Builder of the Year

**AUSBUILD**  
Building with you

QBSA Lic. No 021710



Lot 207  
The Rochedale Estates  
Elara Coastal

Land Price: \$362,500

House Price: \$295,572

Land Size: 478m<sup>2</sup>

House Size: 276.98m<sup>2</sup>

Inc Alfresco: 12.34m<sup>2</sup>

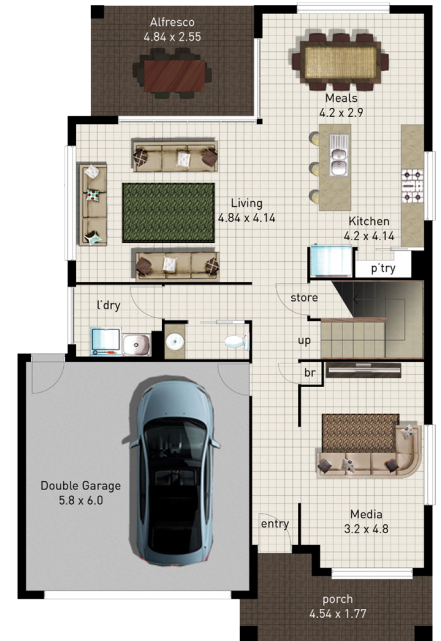

## Contact us

**Scott Wright**

0450 282 600

scott.wright@ausbuild.com.au

[www.ausbuild.com.au](http://www.ausbuild.com.au)

## Inclusions

- Carpet
- Light fitting allowance
- Water tank
- \$5,000 allowance for fencing
- Driveway/Alfresco slab
- Letterbox
- Turf to front
- Tv antenna
- Clothesline